

QUICK
POSSESSION

THE RYO

1,528 SQ FT | 3 BED | 2.5 BATH

289 CREEKSIDE DRIVE SW



THIS DUPLEX HOME FEATURES

- Full-width porch
- Electric fireplace
- Chimney hood fan with built-in microwave and cabinets to the ceiling
- Quartz throughout
- Railing to stairs
- Prepped for a 2 Bedroom Legal Suite (9' Foundation Walls, Side Entrance, 200A Panel, Tankless HWT)
- Gas line for BBQ and Stove

BETTER VALUE BY DESIGN
SINCE 1978 | HOMESBYAVI.COM

Homes by **AVI**

FLOOR PLAN

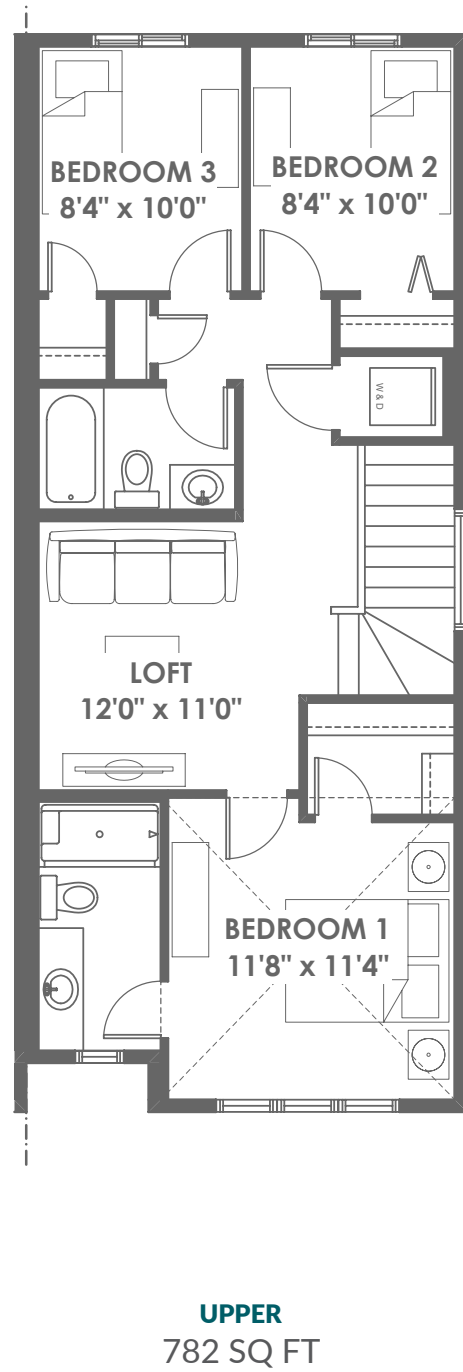
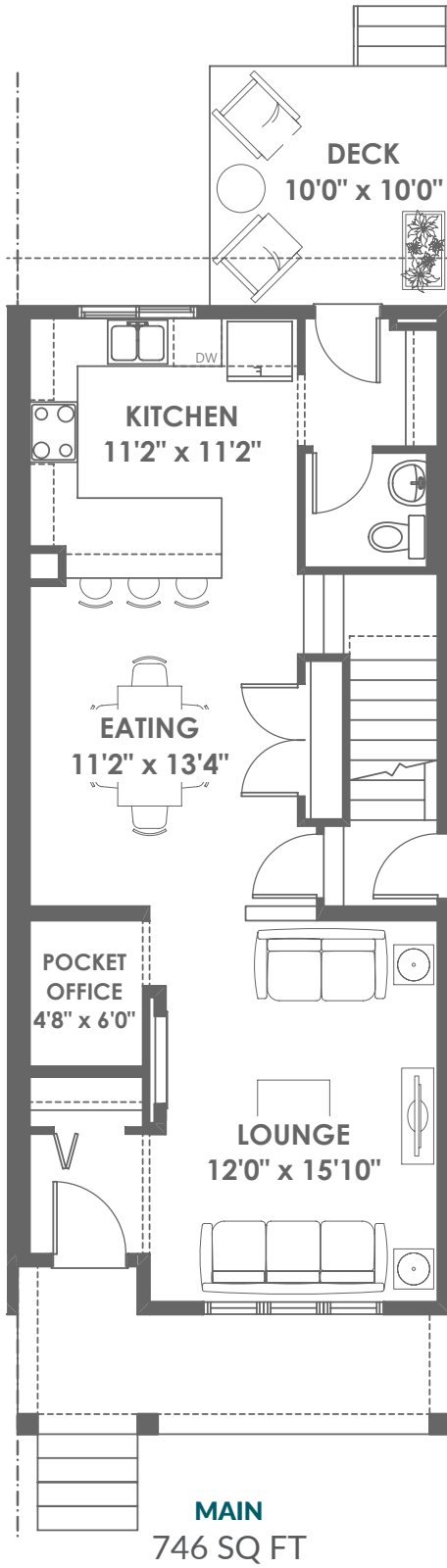

For more information or to book an appointment please contact us at **403.536.7037**

Prices are subject to change without notice. Actual floor plan, elevation, and square footage may not be exactly as shown. Square footage is measured to Alberta Building Code (ABC) regulations. Builder reserves the right to make changes without notice. E&OE.

Homes by **AVI**