

QUICK  
POSSESSION

# THE FINN

1,415 SQ FT | 3 BED | 2.5 BATH

60 BARTLETT WAY SE



## THIS LANED HOME FEATURES

- Open concept floor plan
- Quartz through out Kitchen and Bathrooms
- Rough in for stove and BBQ line
- Stainless steal appliance
- Rear deck
- Side entrance

BETTER VALUE BY DESIGN  
SINCE 1978 | HOMESBYAVI.COM

Homes by **AVI**

# FLOOR PLAN

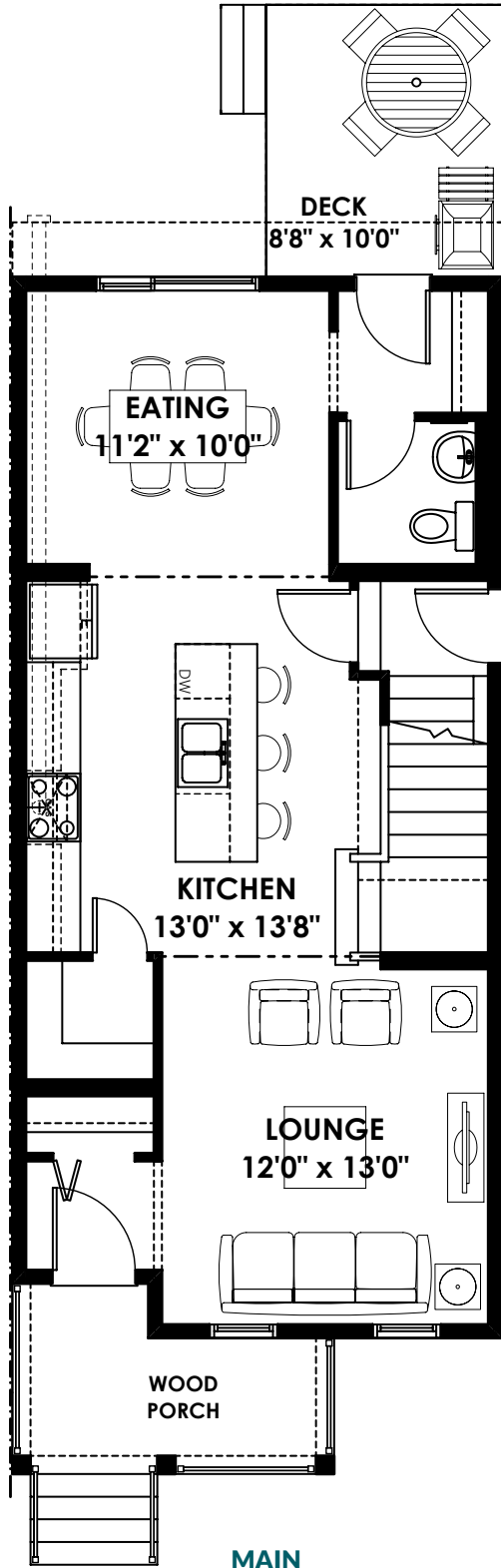

**MAIN**  
692 SQ FT

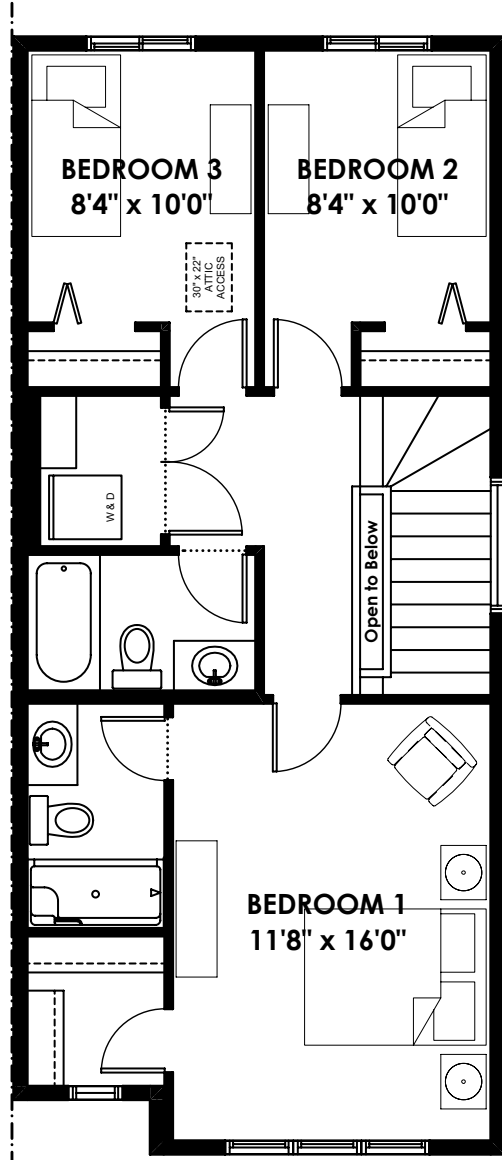

**UPPER**  
723 SQ FT

For more information or to book an appointment please contact us at **403.536.7205**

Prices are subject to change without notice. Actual floor plan, elevation, and square footage may not be exactly as shown. Square footage is measured to Alberta Building Code (ABC) regulations. Builder reserves the right to make changes without notice. E&OE.

Homes by **AVI**