

QUICK  
POSSESSION

# THE FINLEY

1,427 SQ FT | 3 BED | 2.5 BATH

375 SORA BLVD SE



## THIS DUPLEX HOME FEATURES

- Able to accommodate future 2 bedroom legal basement suite (rough-ins, 200 AMP electrical panel, 9' basement foundation walls, side entry already installed)
- Various upgrades include ensuite shower stall, quartz countertops throughout, 42" kitchen cabinets, 400CFM chimney hoodfan, and more
- 20'x20' concrete parking pad
- Rear deck

BETTER VALUE BY DESIGN  
SINCE 1978 | HOMESBYAVI.COM

Homes by **AVI**

## FLOOR PLAN

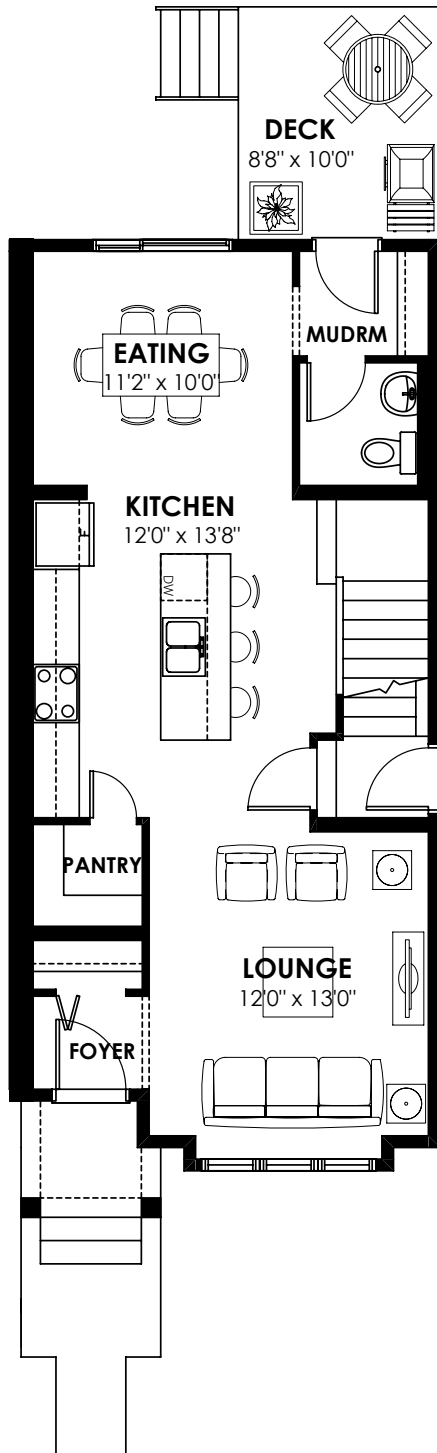

**MAIN**  
701 SQ FT

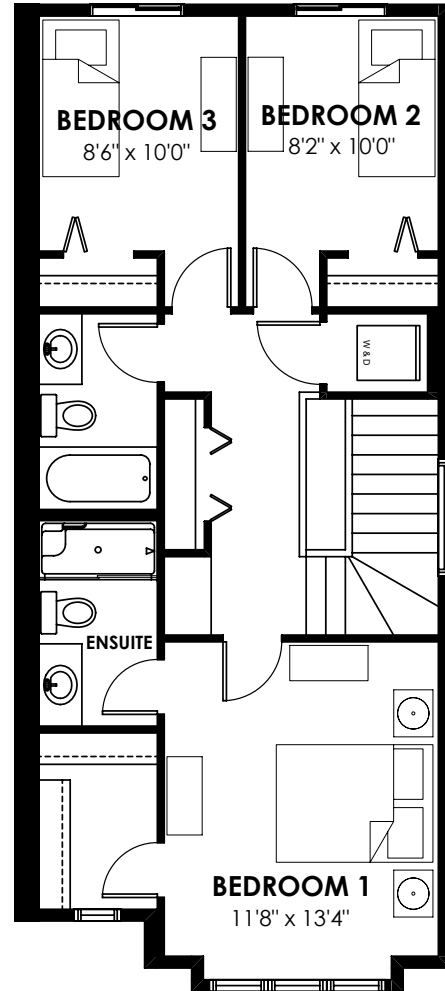

**UPPER**  
726 SQ FT

For more information or to book an appointment please contact us at **403.536.7036**

Prices are subject to change without notice. Actual floor plan, elevation, and square footage may not be exactly as shown. Square footage is measured to Alberta Building Code (ABC) regulations. Builder reserves the right to make changes without notice. E&OE.

Homes by **AVI**