

QUICK
POSSESSION

THE GABRIEL

2,023 SQ FT | 3 BED | 2.5 BATH

2249 - 193A STREET - EDMONTON



THIS FRONT DRIVE HOME FEATURES

- Extended nook and upgraded kitchen.
- Side entrance .
- Pocket office with window upstairs.
- 9' main floor and basement.
- Suite ready basement.
- Bonus room upstairs.
- Upgraded ensuite.

BETTER VALUE BY DESIGN
SINCE 1978 | HOMESBYAVI.COM

Homes by **AVI**

FLOOR PLAN

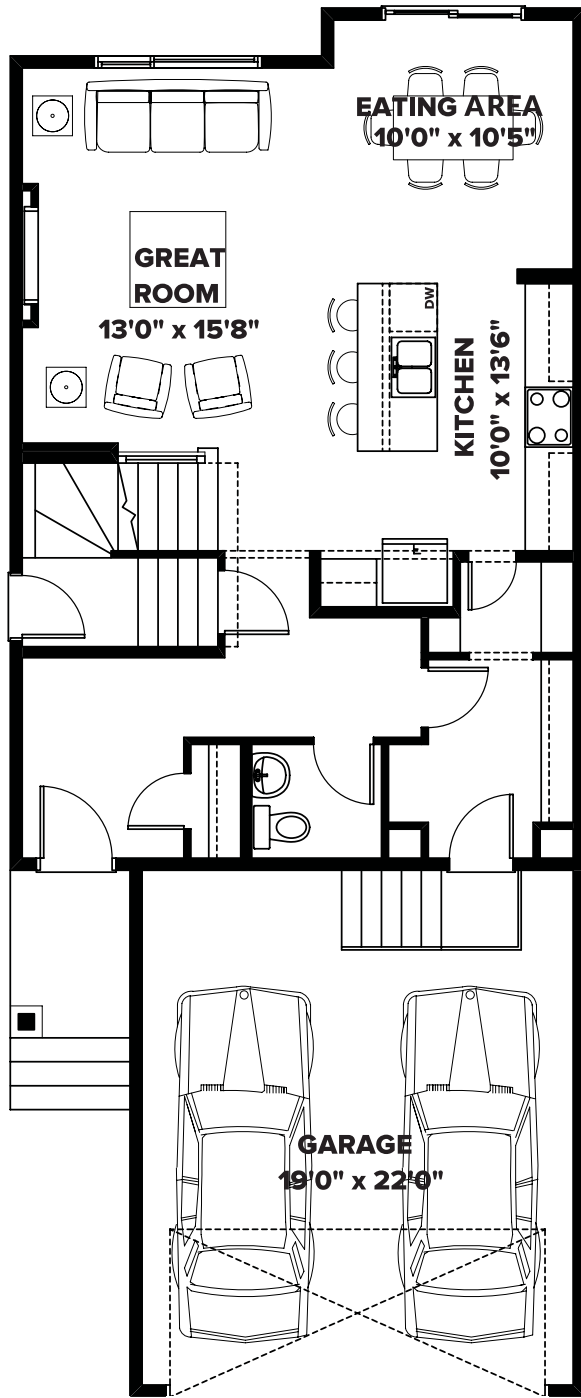

MAIN
838 SQ FT

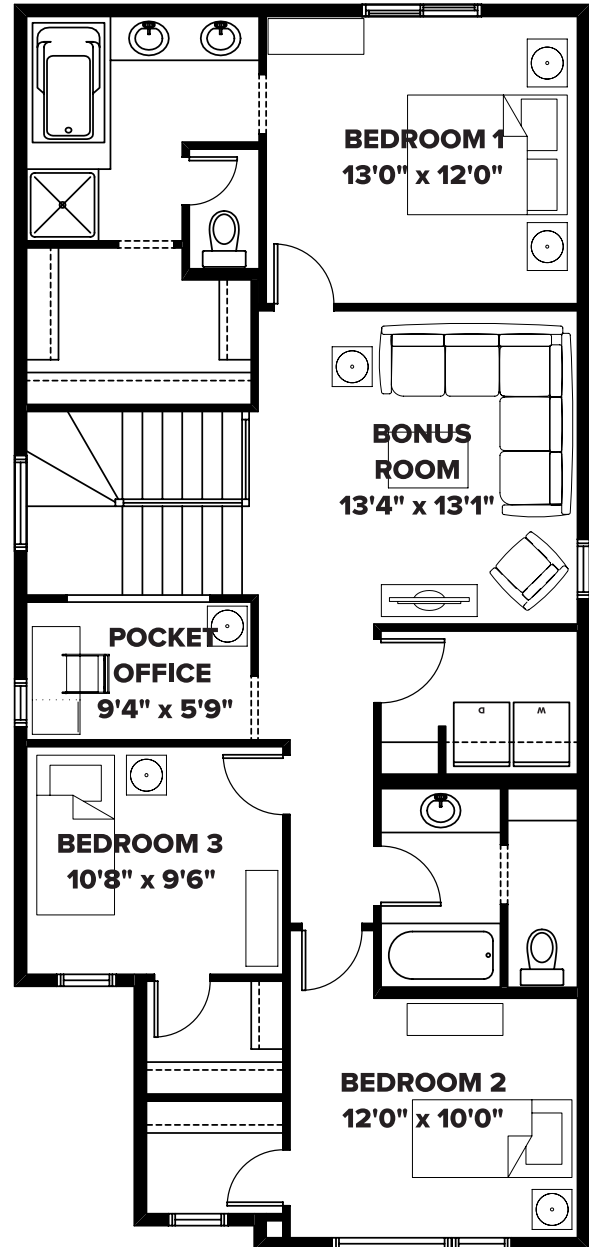

UPPER
1,185 SQ FT

For more information or to book an appointment please contact us at **587.525.5089**

Prices are subject to change without notice. Actual floor plan, elevation, and square footage may not be exactly as shown. Square footage is measured to Alberta Building Code (ABC) regulations. Builder reserves the right to make changes without notice. E&OE.

Homes by **AVI**