



# THE HEMSWORTH

2,551 SQ FT | 4 BED | 3.5 BATH

218 WALCREST VIEW SE



Tucked away, in the final phase of ridge lots in Walden, a well-established SE community, this home offers the perfect blend of urban convenience and natural beauty. Enjoy effortless living with everything you need right just minutes away, including shops, restaurants, healthcare, and wellness services. Explore nature through Walden's extensive pathways, connecting you to parks, playgrounds, ponds, and Fish Creek Provincial Park.

## THIS FRONT DRIVE HOME FEATURES

- Home is located on the ridge, with stunning views
- Open to above Great Room with views of the ridge, upgraded window wall
- Large Eating Room with patio door that opens to the spacious deck
- 10' ceilings on the main floor
- Floor-to-ceiling fireplace with mantle
- Main Floor Flex Room
- Spacious Double-Car Garage
- 4-piece Ensuite set with double sinks, access to walk-in and closet and Laundry Room
- Upper Floor Bonus Room
- Upper Floor Laundry Room
- Fully Developed Basement (524 sq ft) includes recreation room, and additional bedroom
- Direct access from the backyard to community walking paths

BETTER VALUE BY DESIGN  
SINCE 1978 | HOMESBYAVI.COM

Homes by **AVI**

# FLOOR PLAN

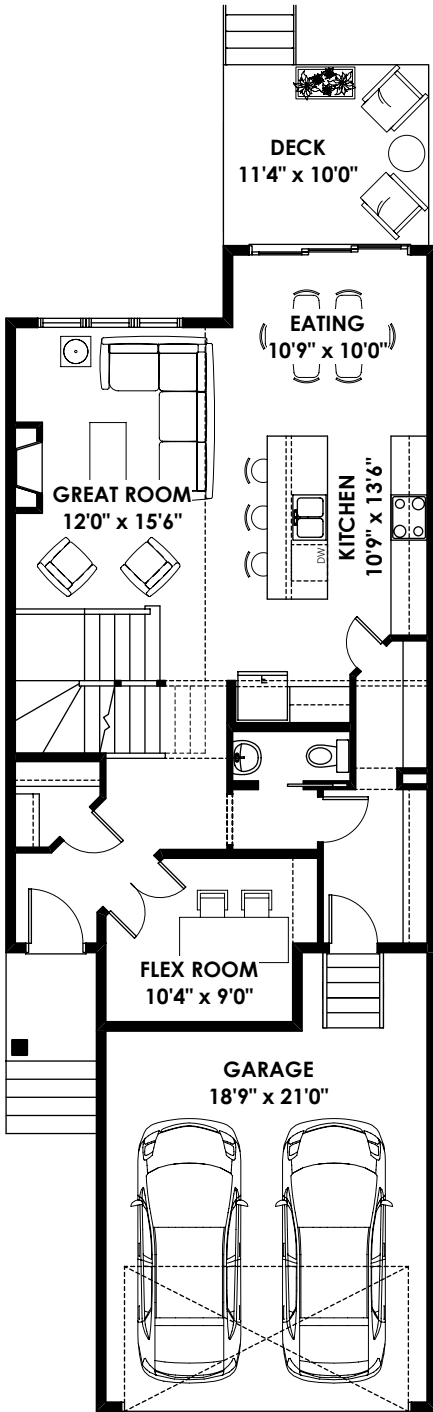

**MAIN**  
927 SQ FT

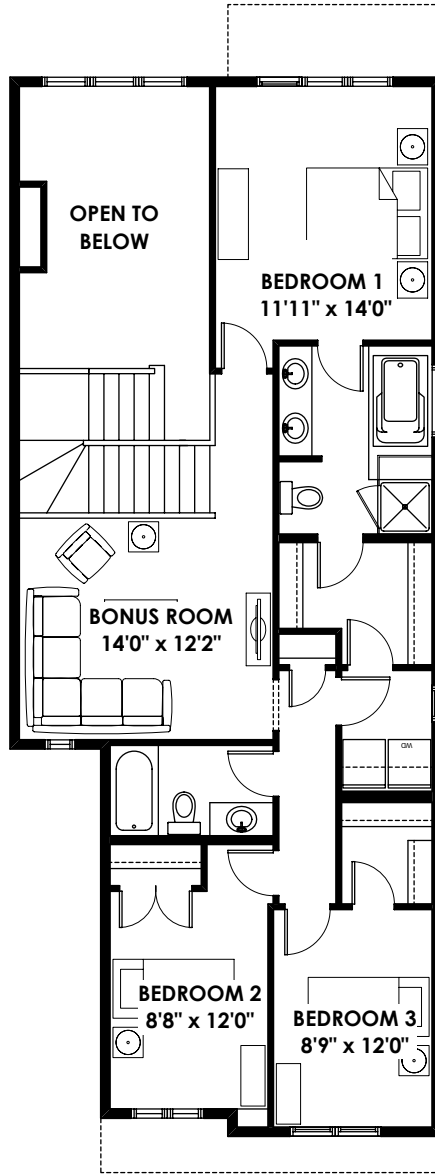

**UPPER**  
1,100 SQ FT

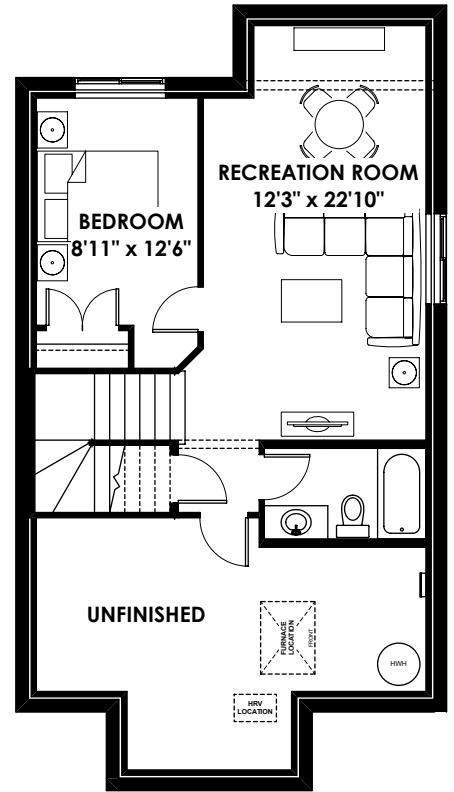

**BASEMENT**  
524 SQ FT

Prices are subject to change without notice. Actual floor plan, elevation, and square footage may not be exactly as shown. Square footage is measured to Alberta Building Code (ABC) regulations. Builder reserves the right to make changes without notice. E&OE.

Homes by **AVI**