

QUICK
POSSESSION

THE FINN

1,415 SQ FT | 3 BED | 2.5 BATH

17235 3 STREET NW



THIS LANED HOME FEATURES

- 9' ceilings.
- Side entry door to basement.
- Quartz countertops.
- Pots and pans drawers w/soft close.
- Luxury vinyl plank flooring.
- Chimney hood fan and appliance allowance.
- 8'8" x 8' deck.

BETTER VALUE BY DESIGN
SINCE 1978 | HOMESBYAVI.COM

Homes by **AVI**

FLOOR PLAN

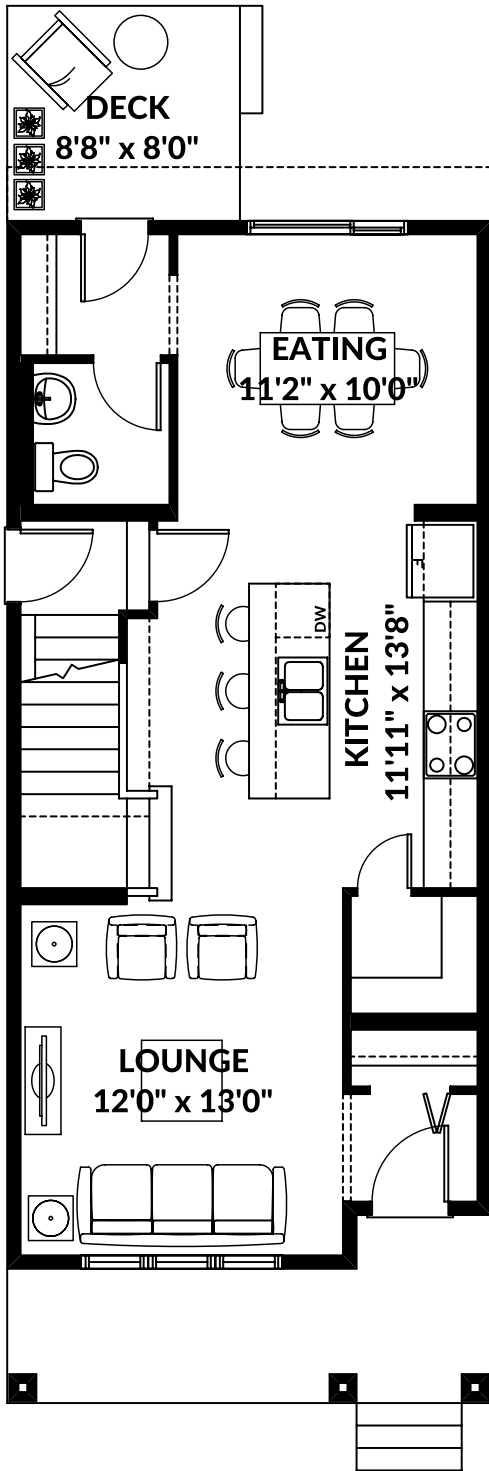

MAIN
692 SQ FT

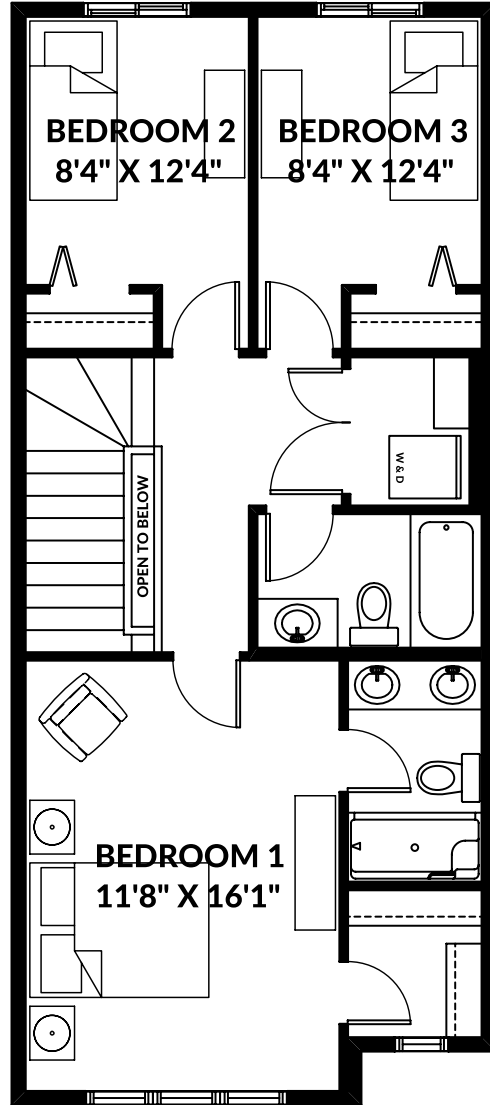

UPPER
723 SQ FT

For more information or to book an appointment please contact us at **587.525.5079**

Prices are subject to change without notice. Actual floor plan, elevation, and square footage may not be exactly as shown. Square footage is measured to Alberta Building Code (ABC) regulations. Builder reserves the right to make changes without notice. E&OE.

Homes by **AVI**