

QUICK
POSSESSION

THE HALLADAY

1,934 SQ FT | 3 BED | 2.5 BATH

5111 71 STREET



THIS FRONT DRIVE HOME FEATURES

- Open to below concept.
- Shiplap fireplace with mantle.
- 9' main floor ceiling height.
- Luxury Vinyl Plank flooring throughout main floor.
- Quartz countertops and under-mount sinks throughout.
- Kitchen chimney hood-fan with built in microwave.
- Rear deck with BBQ gas line.

BETTER VALUE BY DESIGN
SINCE 1978 | HOMESBYAVI.COM

Homes by **AVI**

FLOOR PLAN

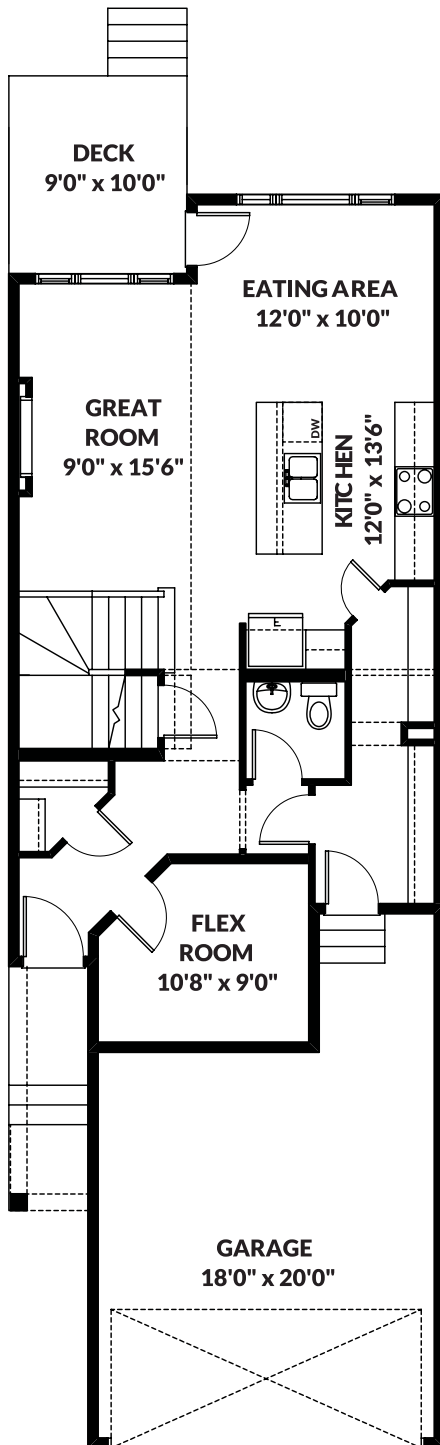

MAIN
856 SQ FT

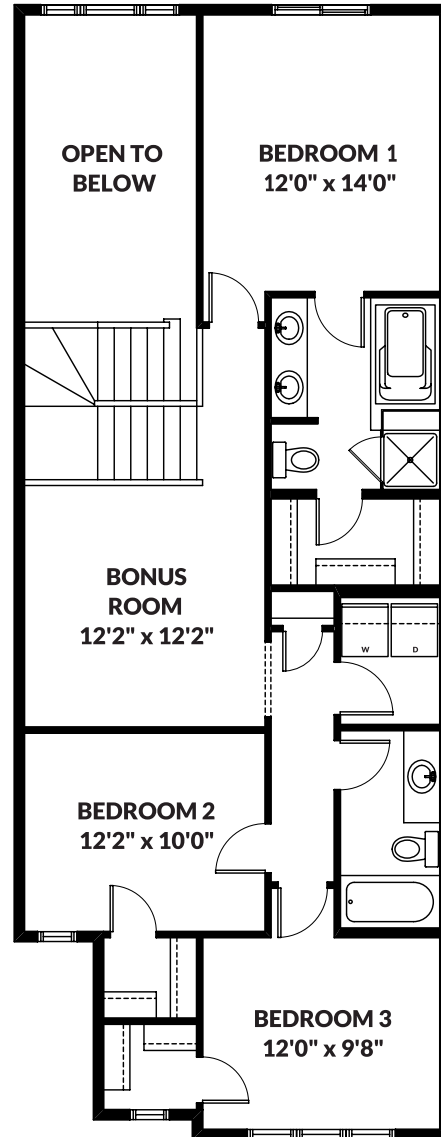

UPPER
1,078 SQ FT

For more information or to book an appointment please contact us at **587.525.5091**

Prices are subject to change without notice. Actual floor plan, elevation, and square footage may not be exactly as shown. Square footage is measured to Alberta Building Code (ABC) regulations. Builder reserves the right to make changes without notice. E&OE.

Homes by **AVI**