

QUICK  
POSSESSION

# THE FINN

1,424 SQ FT | 3 BED | 2.5 BATH

22810 - 82A AVENUE NW



## THIS LANED HOME FEATURES

- 9' main floor ceiling.
- Chimney hood fan.
- Luxury vinyl plank flooring throughout main floor.
- Quartz countertops in kitchen and upper floor bathrooms.
- Pot and pan drawers in kitchen.
- Side entrance for future suite.
- Front landscaping.

BETTER VALUE BY DESIGN  
SINCE 1978 | HOMESBYAVI.COM

Homes by **AVI**

## FLOOR PLAN

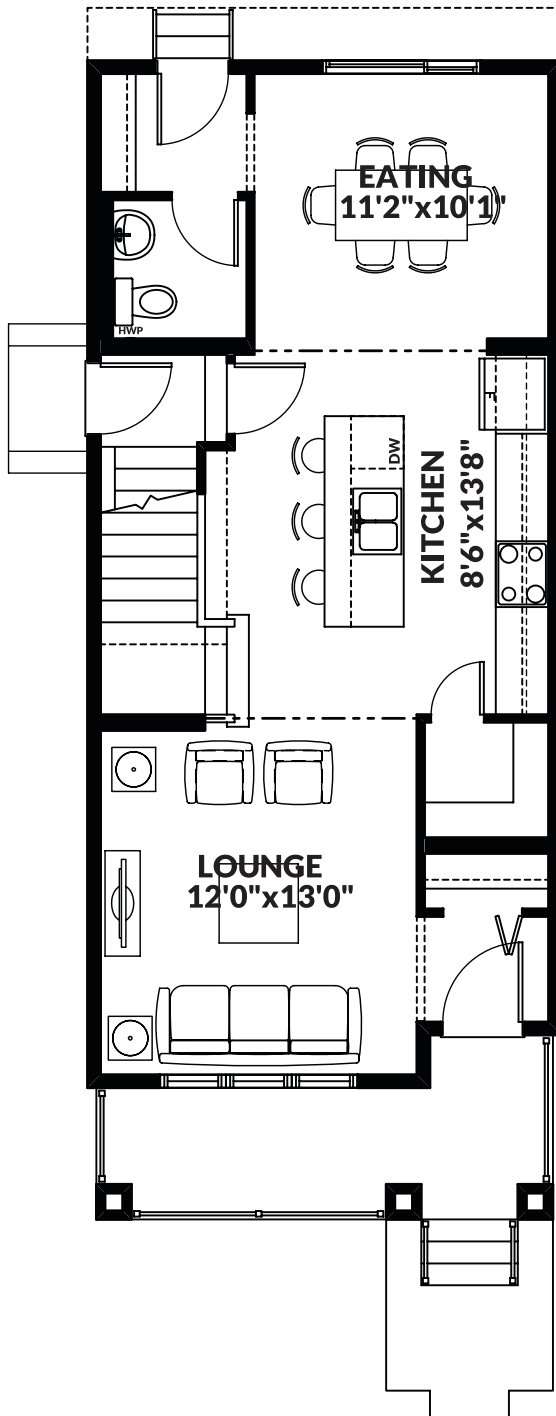

**MAIN**  
692 SQ FT

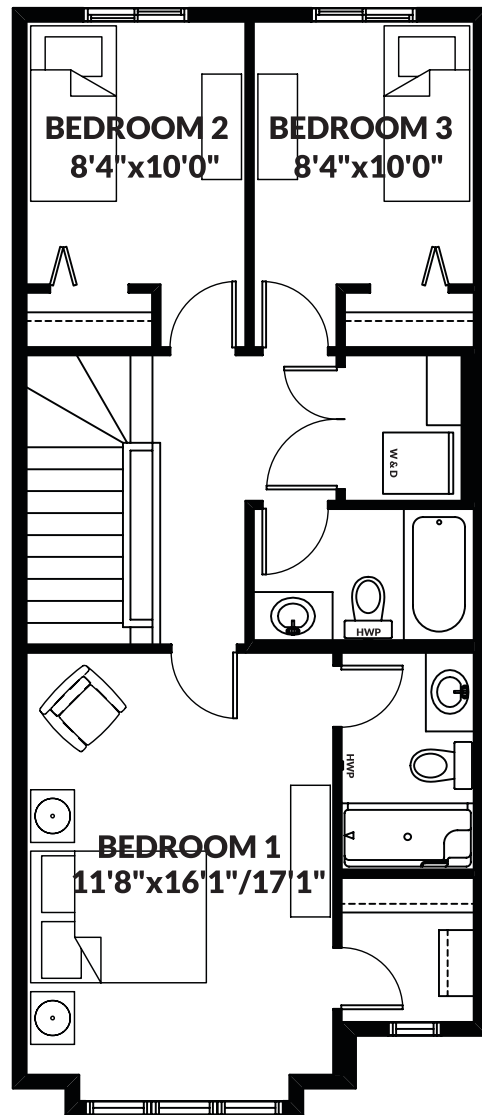

**UPPER**  
732 SQ FT

For more information or to book an appointment please contact us at **587.525.5099**

Prices are subject to change without notice. Actual floor plan, elevation, and square footage may not be exactly as shown. Square footage is measured to Alberta Building Code (ABC) regulations. Builder reserves the right to make changes without notice. E&OE.

Homes by **AVI**