

PHASE 4

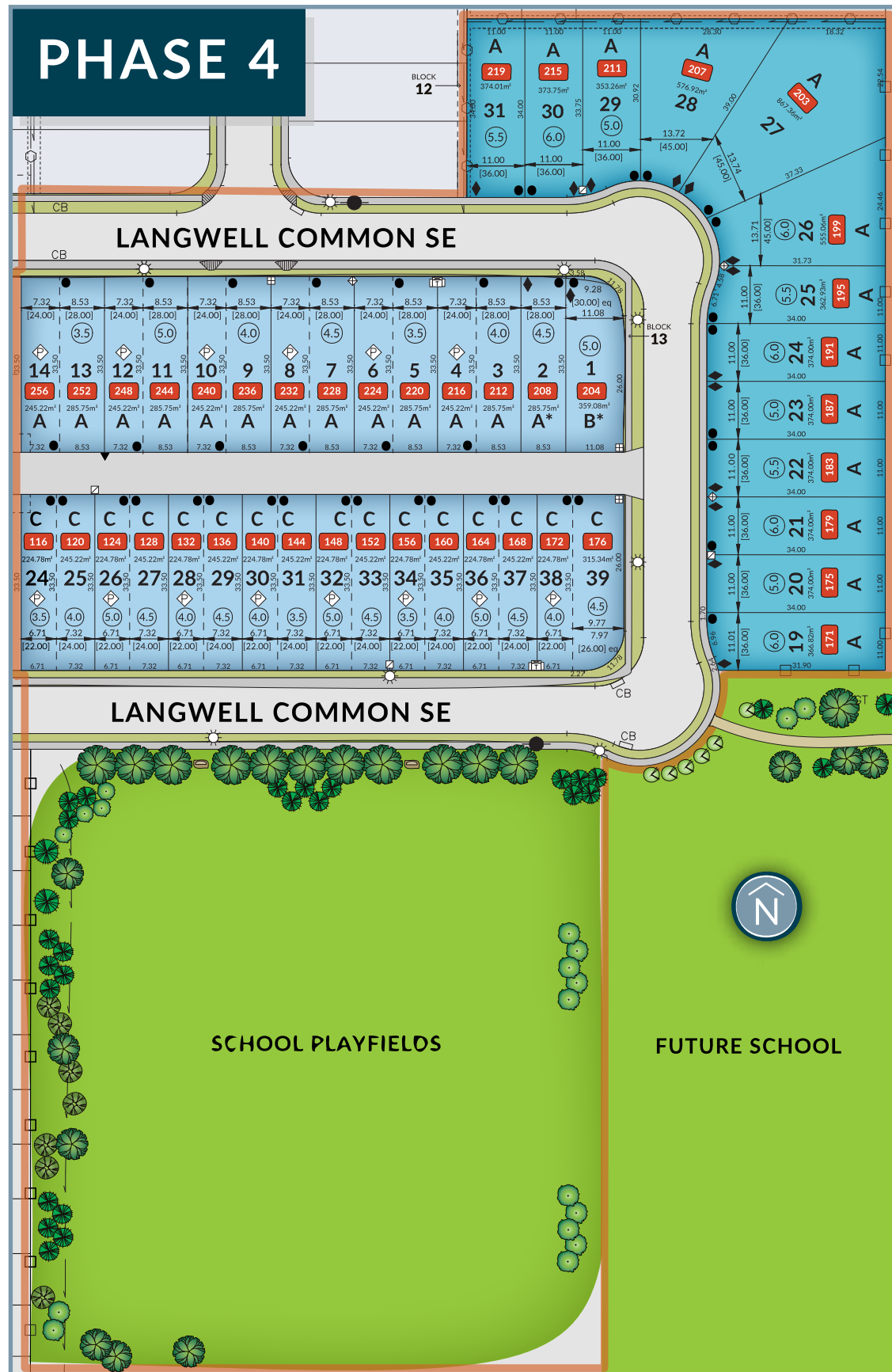

PHASE 4



- ### LEGEND
- 621 MUNICIPAL ADDRESS
 - DRIVEWAY LOCATION
 - HYDRANT
 - STREET LIGHT
 - ELECTRIC TRANSFORMER c/w 3 PARTY JOINT USE PEDESTAL
 - ELECTRIC TRANSFORMER
 - ELECTRIC SWITCH CUBICLE
 - ELECTRIC PULL BOX
 - 3 PARTY JOINT USE PEDESTAL
 - POWER ONLY PEDESTAL
 - SIDE BOX
 - TELUS JWI BOX
 - TELUS PEDESTAL
 - TELUS VAULT BOX
 - SHAW PULL BOX w/ PEDESTAL
 - SHAW PEDESTAL
 - SHAW PULL BOX
 - SHAW POWER SUPPLY
 - COMMUNITY MAILBOX
 - CATCH BASIN
 - PORCH
 - FRONT SETBACK (m)
 - SWALE LOCATION AND FLOW
 - UTILITY RIGHT-OF-WAY
 - OVERLAND DRAINAGE RIGHT-OF-WAY
 - MAINTENANCE EASEMENT
 - WOOD SCREEN FENCE
 - WROUGHT IRON FENCE
 - 200 AMP SERVICE
 - LANED SEMI-DETACHED
 - FRONT DRIVE SEMI-DETACHED
 - LANED SINGLE FAMILY
 - FRONT DRIVE SINGLE FAMILY

LANARK

LANDING

MELCOR

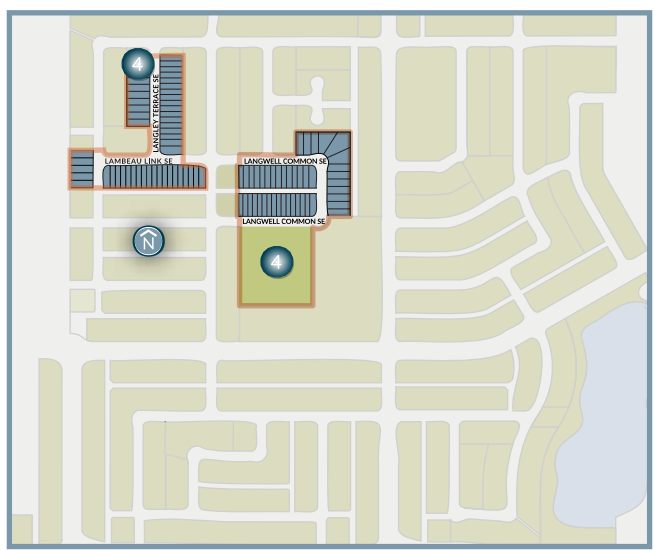

UNIT TYPES

- A** FLAT / SPLIT DRAINAGE
- B** LOWER REAR
- B-2** WALKOUT
- C** BACK TO FRONT DRAINAGE LOT
- *** INDICATES GRADE ADJUSTMENT ON ONE SIDE

NOTE: THIS IS A MARKETING PLAN ONLY, NOT TO BE USED FOR CONSTRUCTION PURPOSES.
 NOTE: THIS INFORMATION IS SUBJECT TO CHANGE. ALL INFORMATION SHOULD BE CONFIRMED ON-SITE WITH THE DEVELOPER AND APPROPRIATE UTILITY COMPANY PRIOR TO PURCHASING A LOT.